

REV.	DESCRIPTION	DATE	BY

CA6 SERIES

3/16" WIRE ROPE

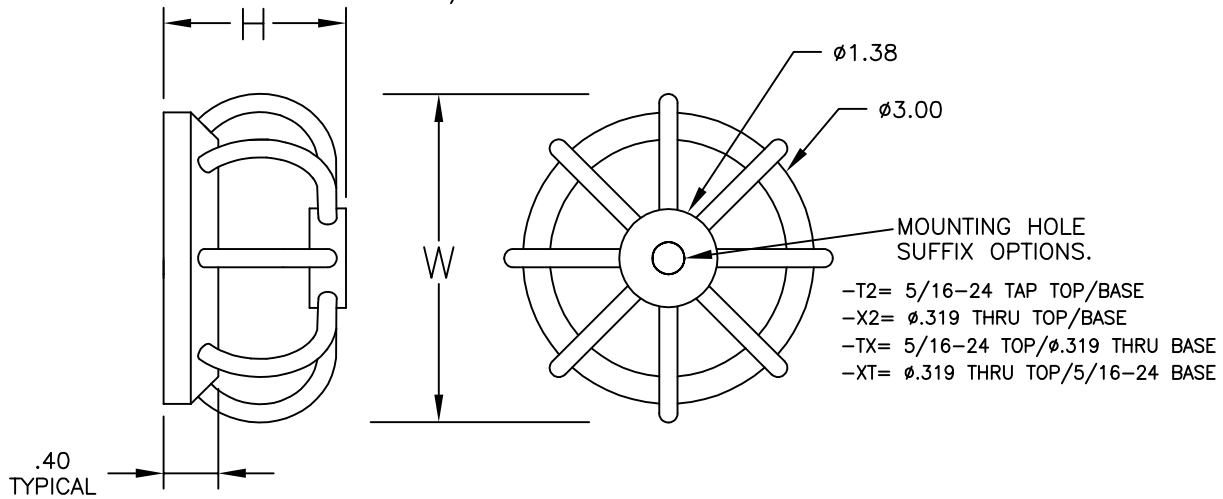

* CROSSED CABLE NOT PICTURED

ISOLATOR PART NO.	NOMINAL DIMENSIONS (in)		LOAD MODE	SHOCK AVERAGE K (lb/in)	VIBRATION AVERAGE K (lb/in)	MAX. RATED DYNAMIC TRAVEL (in)
	H \pm .06	W(REF)				
CA6-250-08-[]	1.75	3.38	COMPRESSION SHEAR 45 DEG. C/R	400 260 250	990 230 790	.45 .40 .75
CA6-300-08-[]	2.13	3.63	COMPRESSION SHEAR 45 DEG. C/R	210 95 100	480 75 305	.60 .65 1.10
CA6-350-08-[]	2.50	4.00	COMPRESSION SHEAR 45 DEG. C/R	120 35 55	325 45 190	.70 .95 1.35
CAX6-[] (CROSSED CABLE)	2.00	3.90	COMPRESSION SHEAR 45 DEG. C/R	140 145 80	410 115 245	.65 .50 1.20

OTHER MATERIALS, COMPOUNDS, OR FINISHES WITH EQUAL OR SUPERIOR PROPERTIES MAY BE SUBSTITUTED AS THEY BECOME AVAILABLE.

CERTIFIED FOR:

JOB NAME: _____
 CUSTOMER: _____
 CUSTOMER P.O.: _____
 SALES ORDER: _____

**MODEL CA6 SERIES
 ALUMINUM ARCH WIRE ROPE
 ISOLATOR**



THE VMC GROUP
The Power of Together
 Bloomingdale, NJ 07403
 Houston, TX 77041

SCALE:
 NONE
 SHEET:



DRAWING NO.: _____ REVISION