

REV.	DESCRIPTION	DATE	BY

PART NO.	MODEL NO.	AXIAL STATIC LOAD MAX LBS.	RADIAL STATIC LOAD MAX LBS.	DUROMETER ±5	COLOR CODE	MATERIAL
770005-1	RB1-60	60	30	40	RED	BR BRG NEO
770005-2	RB1-120	120	40	60	GREEN	BR BRG NEO
770005-3	RB1-200	200	50	70	YELLOW	BR BRG NEO
770005-3WR	RB1-200 WR	200	50	70	CHARCOAL GREY	DURULENE
770005-4	RB1-300	△	△	80	BLACK	BR BRG NEO
770005-7	RB1-60EHT	60	30	40	DK BLUE	EHT SILICONE

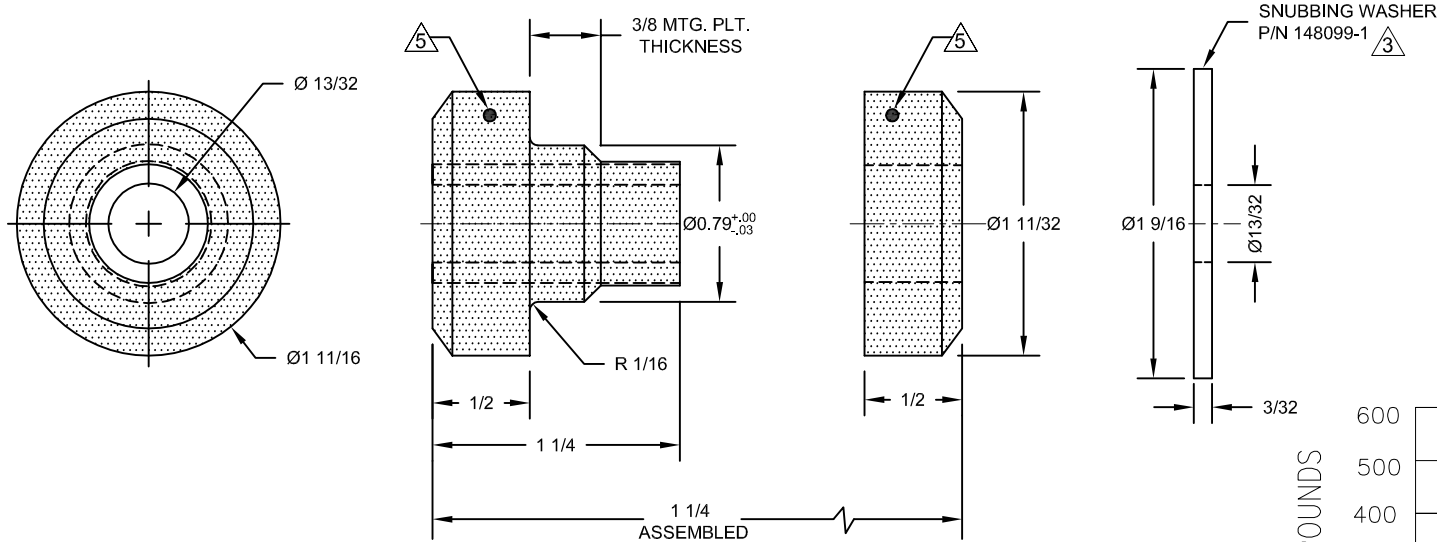

AXIAL LOAD Vs. DEFLECTION

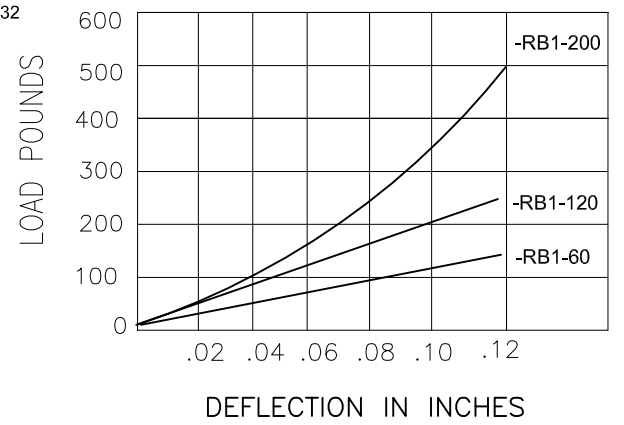

- NOTES:
1. ALL DIMENSIONS ARE IN INCHES .INTERPRET PER ANSI Y14
 2. ALL DIMENSIONS ARE NOMINAL AND FOR REFERENCE ONLY.
 3. SNUBBING WASHER IS OPTIONAL, ORDER SEPERATE ON PURCHASE ORDER.
FINISH :YELLOW ZINC PLATED PER ASTM B633 TYPE II, CLASS SC 3 UNLESS OTHERWISE SPECIFIED .
 4. COLOR-CODE "MARK "IS AN ACCEPTABLE ADDITION TO MODEL STAMPING .
 5. STAMPING SURFACE LOCATION AS MARKED ON DRAWING.
 6. CURRENTLY UNDER ENGINEERING REVIEW CONTACT VMC FOR AVAILABILITY
 7. 13/32" HOLE FOR 3/8" BOLT

OTHER MATERIALS, COMPOUNDS, OR FINISHES WITH EQUAL OR SUPERIOR PROPERTIES MAY BE SUBSTITUTED AS THEY BECOME AVAILABLE.

CERTIFIED FOR:

JOB NAME: _____

CUSTOMER : _____

CUSTOMER P.O.: _____

SALES ORDER: _____

**MODEL RB1 60-200 LBS.
RING AND BUSHING
ELASTOMERIC ISOLATOR**

THE VMC GROUP
The Power of Together
Bloomington, NJ 07403
Houston, TX 77041

SCALE:	NONE	
SHEET:	1 OF 1	
DRAWING NO.:		REVISION